

Address	139 Windford Crescent SW, Airdrie, AB
Date	May 24, 2019
Name	Stacey Jamieson Re/Max Realty Professionals
Email	staceyj@remax.net
Phone	403.993.6595

FLOOR TOTALS

Main Level	525.49 sqft / 48.82 m2	Total Size	1315.16 sqft / 122.18 m2
Upper Level	531.28 sqft / 49.36 m2	Order Procedure	RECA RMS
Lower Level	258.39 sqft / 24.00 m2	Exterior Wall Size	NA
		Order Type	Townhouse

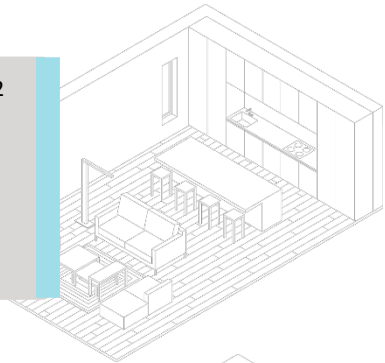

ROOM DIMENSIONS

Kitchen	13'4" X 10'2" ft/in	M	Laundry / Utility	9'0" X 8'6" ft/in	L
Dining Area	12'0" X 8'8" ft/in	M	Balcony	12'0" X 8'0" ft/in	M
Living Room	13'5" X 11'9" ft/in	M	Garage	23'5" X 10'3" ft/in	L
Porch	10'0" X 6'6" ft/in	L			
Foyer	8'6" X 6'4" ft/in	L			
Mud Area	10'8" X 4'4" ft/in	L			



BEDROOM DIMENSIONS

Master	11'5" X 11'5" ft/in	U	Additional	0'0" X 0'0" ft/in	NA
Bedroom Two	11'5" X 9'5" ft/in	U			
Bedroom Three	9'5" X 8'8" ft/in	U			

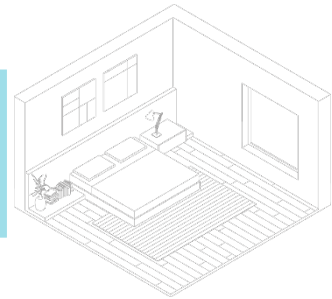

BATHROOM PIECES AND ADDITIONAL ROOMS

0 - One Piece	NA	Additional	0'0" X 0'0" ft/in	NA
1 - Two Piece	M			
0 - Three Piece	NA			
1 - Four Piece	U			
0 - Five Piece	NA			

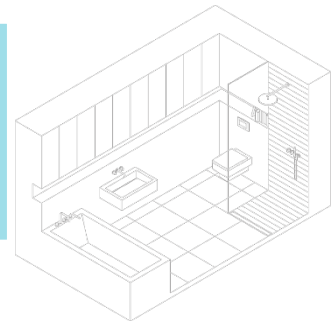

*Insured measurements are based on local guidelines.